

HOW TO INSTALL:

RECOVERY BOARD MOUNTS



RECOVERY BOARD MOUNT HARDWARE

Quantity	Type	Thread	Length	Mat/Type	Finish
4ea	Bolt	1/2-13	6	Grade 5	Zinc
8ea	Washer	1/2	N/A	Grade 5	Zinc
4ea	Bolt	1/2-13	1 1/2	Grade 8	Cadmium
8ea	Washer	1/2	N/A	Grade 8	Cadmium
4ea	Lock Nut	1/2-13	N/A	Grade 8	Cadmium
4ea	Knob	1/2-13	N/A	Plastic	None
4ea	Spacer	1/2	N/A	Plastic	None
2ea	Backer	N/A	N/A	Steel	Powder

RECOVERY BOARD MOUNT TOOLS

Quantity	Type	Size	Notes
2ea	Wrench	3/4	
N/A	Misc (Optional)	N/A	Any tools for your brands mounting pins

Step 1

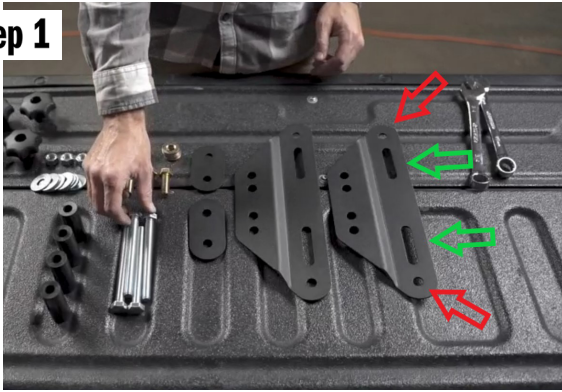

First we need to install the mounting pins for the recovery boards. You can use the included hardware, or the pins sold by the various recovery board brands. For Maxtrax install your pins/hardware at the RED locations. For all others like Tread or Amazon use the GREEN.

Step 2



To use the included hardware start by placing a large washer on the long $\frac{1}{2}$ " bolt. Push the bolt through the mount, so that the head of the bolt is inside the channel, as show in the picture. Then place another washer on the bolt, then thread a nut all the way down. Snug the nut so it is not flopping around, but can be adjusted in later steps. Do this for all 4 locations on both mounts.

Step 3



Now we will install the mount to your bed rack. Grab a gold (grade 8) bolt and put on a washer, then put that bolt through the mount, the same side as the pins. Use the inner holes. Line these up with the slots on your bed rack.

Step 4

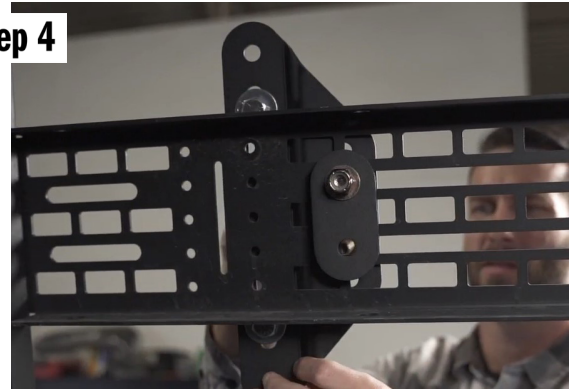

Next grab the oval backing plate and slide it over the bolt, then install a washer and lock nut. Do this for both positions, and on both mounts. Tighten these until they are not floppy, but still able to be adjusted.

Step 5



With the mounts up, we will now put our recovery boards on the mounts. Slide them over the pins. Then install the plastic spacer and knobs in all 4 positions. Tighten these so the boards are firmly attached to the mounts.

Step 6



Now that the recovery boards are in place, adjust your mounts left to right. Using your $\frac{3}{4}$ " wrenches, tighten the mounts to the bed rack. Then adjust the recovery boards up and down (only for boards that are in the green slots). With the boards in the desired position, tighten the pins/bolts to the mounts.